

DMX512 AC Switch

Model No.: DP

RDM/Stand-alone function/Numeric display



CE RoHS EMC LVD

Features

- DMX512 decoder a control power on/off to cater for unwanted dimming lighting system.
- One channel output, AC input and AC output, only one DMX512 address.
- Comply with the DMX512 standard protocols.
- Digital numeric display, set DMX decode start address by buttons.
- RDM function can realize intercommunication between DMX master and decoder.
For example, DMX decoder address can be set by DMX master console.
- Stand-alone manual on/off mode selectable, which be controlled by buttons, instead of DMX signal.

Technical Parameters

Input and Output	
Input voltage	AC100-240V
Output voltage	AC100-240V
Output current	Max 5A
Output power	500-1200W

Environment	
Operation temperature	T _a : -30°C ~ +55°C
Case temperature (Max.)	T _c : +85°C
IP rating	IP20

Safety and EMC	
EMC standard (EMC)	EN 55015:2013
	EN 61547:2009
	EN 61000-3-2:2014 EN 61000-3-3:2013
Safety standard(LVD)	EN 61347-2-11:2002
	EN 61347-1:2015
	EN 62493:2015
Certification	CE,EMC,LVD
Warranty	
Warranty	5 years

Mechanical Structures and Installations

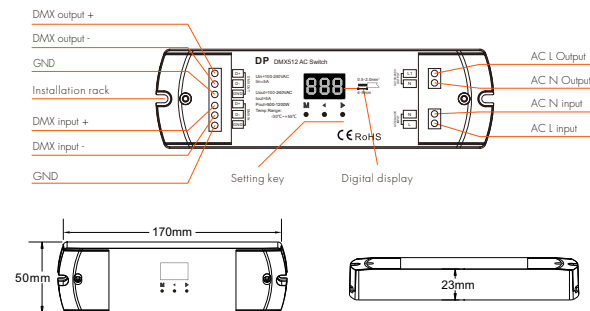

Wiring Diagram

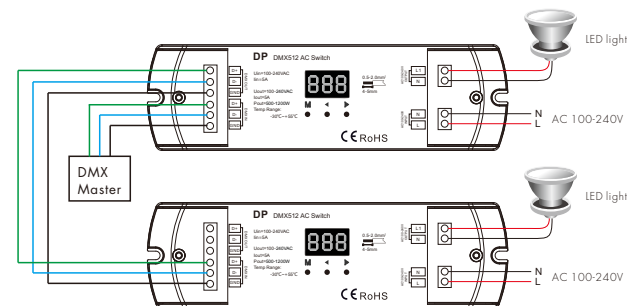

Note:

1. An DMX signal amplifier is needed if more than 32 decoders are connected, or use overlong signal line, signal amplification should not be more than 5 times continuously.
2. If the recoil effect occurs because of longer signal line or bad line quality, please try to connect 0.25W 90-120Ω terminal resistor at the end of each DMX signal line.
3. If output connect with capacitive or inductive load, the maximum output current only up to 5A.
If output connect with resistive load, the maximum output current may up to 1.5A.

Operation

System parameter setting

- Long press M and ◀ key in the same time for 2s, prepare for setup system parameter: automatic blank screen.
- Short press ◀ or ▶ key to switch enable ("bon") or disable ("boF") automatic blank screen.
- Long press M key for 2s or timeout 10s, quit system parameter setting.

DMX mode

- Short press M key, when display 001~999, enter DMX mode.
- Press ◀ or ▶ key to change DMX decode start address (001~999), long press for fast adjustment.
- If there is a DMX signal input, will enter DMX mode automatically.
- DMX control: Each DP DMX decoder occupy 1 DMX address when connecting the DMX console.



DMX mode
(001~999)

Stand-alone manual on/off mode

- Enter stand-alone manual on/off mode only when DMX signal is disconnected or lost.
- Short press M key, when display "Pon" or "PoF", enter manual on/off mode.
- Press ◀ or ▶ key to change power on or off state.



Power on



Power off

Restore factory default parameter

- Long press ◀ and ▶ key for 2s, restore factory default parameter, display "RES".
- Factory default parameter: DMX decode mode, DMX decode start address is 1, disable automatic blank screen.